

LG-330TD EXPLODED DIAGRAM

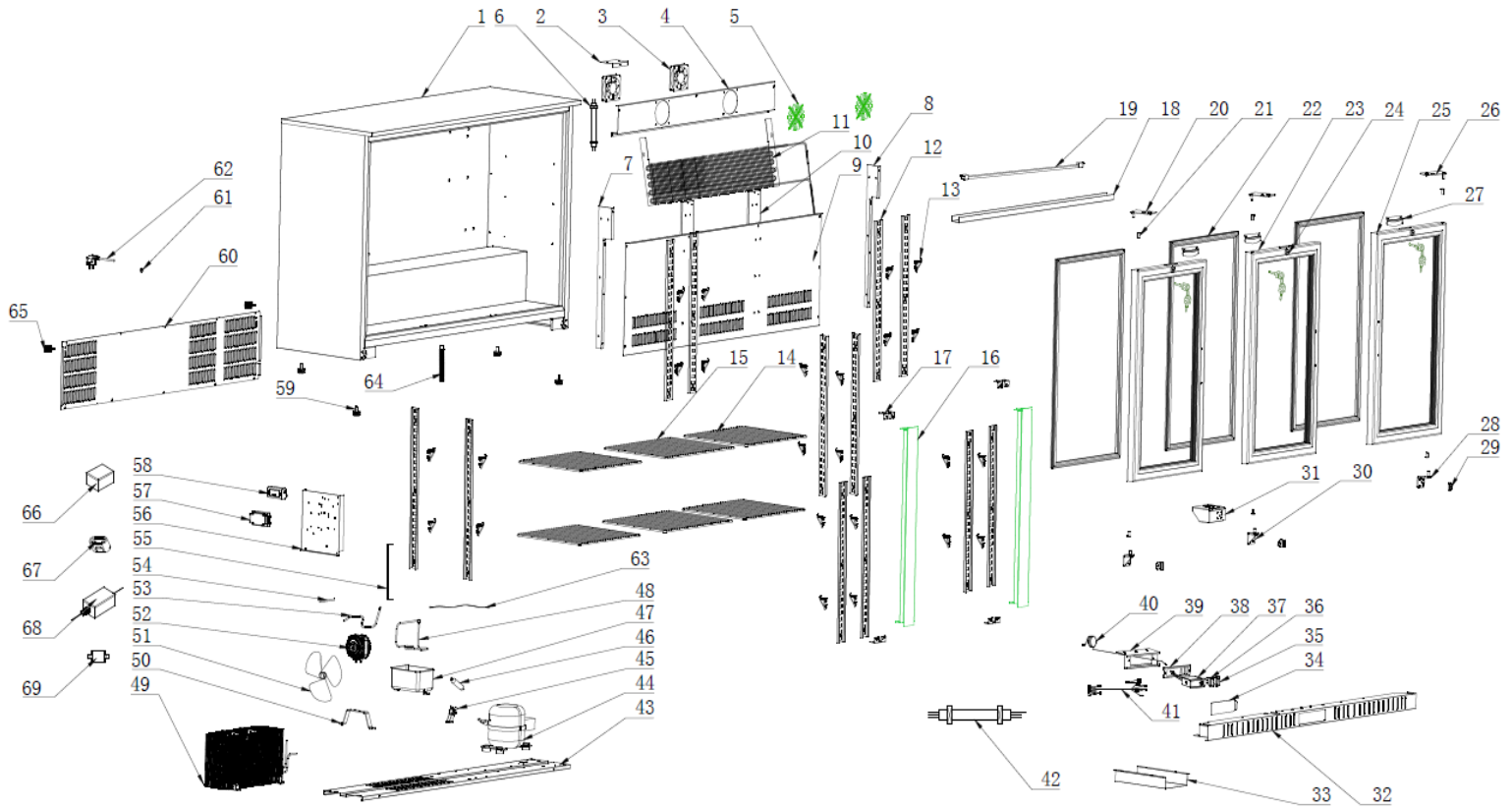

FHE After Sales Service & Support (AU)
Phone: 1300887055
Spares Email: spares@fedservices.com.au

FHE After Sales Service & Support (NZ)
Phone: 09 415 6471
Service Email: service@fedproducts.co.nz

LG-330TD PARTS LIST

Item	FHE Part Code	Description	Qty
1	—	Foaming Cabinet	1
2	F.300.004.248HC-005	Air Deflector Support B	1
3	M.200.002.SDQ-SAD12038B12L-02/2	Evaporation Fan	2
4	F.203.001.330HA-001	Fan Plate	1
5	T.403.005.338FA-001	Fan Cover	2
6	M.5L1.003.330HA-029	DC Motor Connection Wire	1
7	F.300.004.208HC-013-B	Left Air Deflector Support	L
8	F.300.004.208HC-014-B	Right Air Deflector Support	1
9	F.300.003.330HC-017	Air Deflector	1
10	F.300.002.208HC-014-B	K-bar Mounting Plate	2
11	N.15B.002.330HA-008	Evaporator	1
12	T.202.001B.208HC-334-02	K-Bar	12
13	T.204.002.1000WBA-007	K-Clamp	24
14	P.107.208H-001	Shelf	4
15	P.107.330H-001	Shelf B	2
16	C.03.002X.208HC-015-HZ	Middle Vertical Beam	2
17	F.103.004.208HA-007	Middle Vertical Beam Mounting Plate	4
18	DZ.501.003.330HA-1268-03	Light Pipe Cover	1
19	M.305.004.1100-2835-30-01-B-SM	LED Light	1
20	T.402.003.208HA-032L-HZ	Left Upper Door Hinge	2
21	DM.706.005.228FA-001-H	Door Shaft Sleeve	6
22	DM.60R.330HC-005-H	Door Gasket	3
23	C.02.006.330HC-030BL-H-AA	Left Door Assembly	2
24	T.402.001.208HA-001	Key Set	3
25	C.02.006.330HC-030BR-H-AA-092	Right Door Assembly	1
26	T.402.003.208HA-032R-HZ	Right Upper Door Hinge	1
27	T.402.002.208HA-001-H	Handle	3
28	T.402.003.208HA-031-HD	Right Lower Door Hinge	1
29	T.402.007.330HA-002	Iron Support Fixing Part	3
30	T.402.003.208HA-030-HD	Left Lower Door Hinge	2
31	T.403.010.330HA-006	Door Hinge Mounting Nut Plate	1
32	F.207.001.330HA-041-HZ	Front Trim Panel	1
33	T.403.010.208HA-011	Wire Trunking	1
34	DZ.708.008.208HA-007	Appliance Cover	1
35	M.302.001.208HA-003	Power Switch-Red (with waterproof cover)	1

LG-330TD PARTS LIST

Item	FHE Part Code	Description	Qty
36	M.302.001.208HA-004	Light Switch-Green (with waterproof cover)	1
37	M.401.002.ECS-16-01	Electronic Temperature Controller	1
38	DZ.708.008.208HA-005-H	Temperature Gauge Plate C	1
39	DZ.708.008.208HA-006-H	Temperature Gauge Plate Assembly	1
40	M.401.002.ECS-16-2500	Temperature Probe Wire	1
41	M.5L2.001.360FA-009	Wiring Harness of Electronic Temperature Controller	1
42	M.5L2.003.330HA-059	Compressor Wiring Harness	1
43	F.201.001.330HA-013	Compressor Plate	1
44	M.10P.PZ99H1X	Compressor	1
45	DZ.708.010.1000WBA-004-H	Dry Filter Retaining Clip	1
46	N.101.228FA-001	Dry Filter	1
47	DZ.708.003.660WA-001	Basin	1
48	N.300.002.208HA-009	Exhaust Pipe	1
49	N.20C.330HA-007	Steel Wire Condenser	1
50	T.403.003.208HA-003	Condensing Motor Support	1
51	T.403.005.660WA-002	Fan Blade	1
52	M.200.001.208HA-009/2	Condensing Motor	1
53	N.300.004.138HC-001	Connecting Pipe for the Return Air Pipe	1
54	N.300.003.208HA-001	Compressor Process Pipe	1
55	T.403.006.330HA-001	Support of Compressor Plate	1
56	F.202.001.208HA-008	Electrical Installation Plate	1
57	DZ.708.005.660WA-001/2	Junction Box	1
58	M.405.001.HS-EVS-A120150N-A0C-W1	12 V Constant Voltage Supply (18 W)	1
59	DZ.708.008.208HA-007	Adjustable Foot	4
60	F.208.001.330HA-013	Rear Sealing Plate of Compressor Compartment	1
61	T.203.001.001	Guard Coil	1
62	M.600.E3-075-2200-H-W12	Power Cord	1
63	M.5L2.228FA-001	Compressor Grounding Wire	1
64	T.211.003.208HA-003-H	Inner Cabinet Drain Pipe	1
65	DZ.708.004.BJ9A-001-H	The Foot to the Wall	1
66	M.408.248HC-HT125-10-L8-B3	Filter	1
67	DZ.708.010.660WA-004	Power Cord Clamp	1
68	M.405.001.D150WA-002	Electrical Heating Door Power Supply	1
69	T.403.010.D150WA-001	Fixing Support for the Electrical Heating Door Power Supply	1